

PLEASANT GROVE BOULEVARD

SEE SHEET L 1.4
MATCH LINE

PLANT SCHEDULE

TREES	CODE
	ARB STR
	ARB MAR
	GED DEO
	CER FOR
	COR FLO
	LAG CAT
	LAG NAT
	PIN ELD
	PIS KEI
	PLA COL
	PRU CAR
	PRU SER
	ULM TRU

SEE SHEET L1.5 FOR FULL
PLANT SCHEDULE

SEE SHEET L 1.2
MATCH LINE



JEFF AMBROSIA, ASLA C4057
1223 HIGH STREET
AUBURN, CALIFORNIA 95603
(530) 885-0040
FAX (530) 885-0042
www.yamasaki-la.com

WESTPARK W16 APARTMENTS
LANDSCAPE DEVELOPMENT PLANS
PLEASANT GROVE BOULEVARD
ROSEVILLE, CALIFORNIA

These drawings are instruments of service and are the property of Yamasaki Landscape Architecture. All designs and other information on the drawings are for the use on the specified project and shall not be used otherwise without the express written permission of Yamasaki Landscape Architecture.

Sheet Title
PLANTING PLAN A



No.	Date	Revision
▲		
▲		
▲		
▲		

Project Mgr.: JMA Sheet No.:
Drawn By: JMA
Scale: 1"=20'-0" L1.1
Date: 4/2/21
File Name: W16 PL of _____ sheets

DC EXHIBIT F

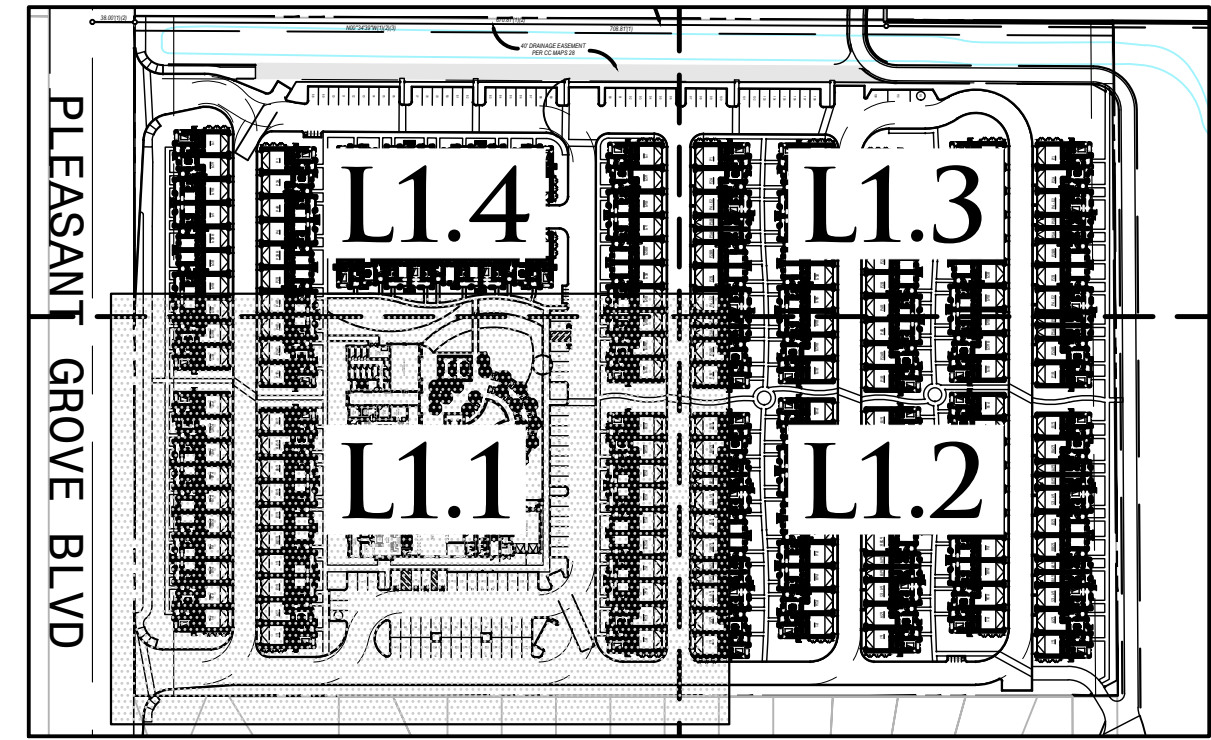

VICINITY MAP

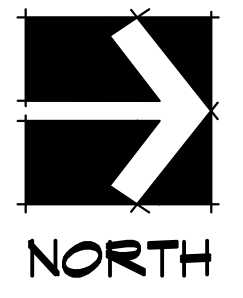
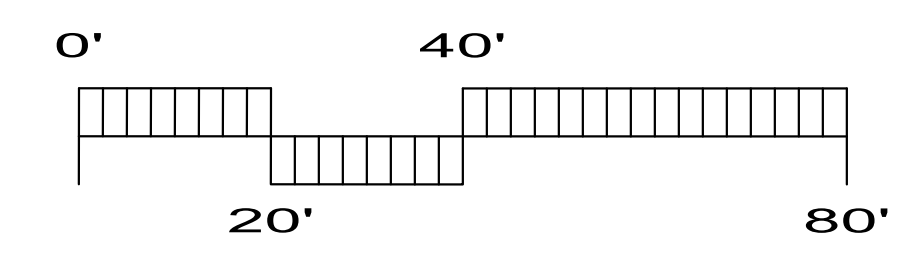

S:\016\Westpark W16 Apartments\DWG\A\DO\W16_PL.dwg (L1.1) 2021 04/02 09:58 AM by: Jeff Ambrosia

PLANT SCHEDULE

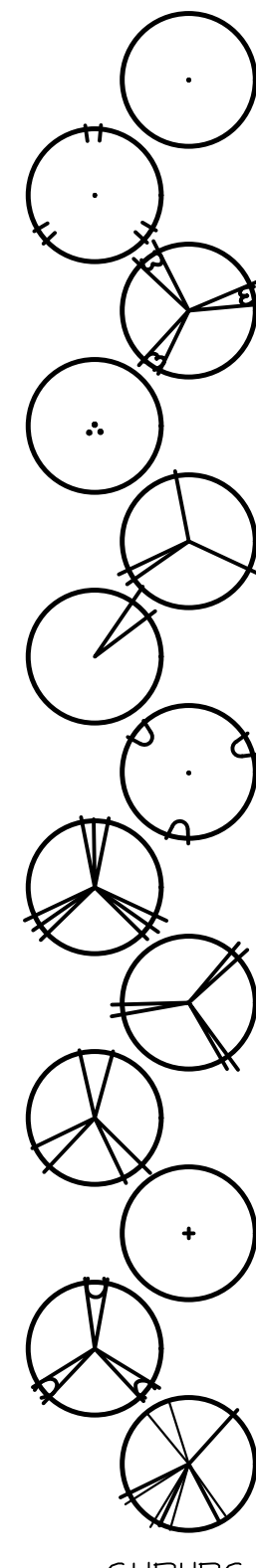

SHRUBS

TREES	CODE	BOTANICAL / COMMON NAME	SIZE
	ARB STR	Arbutus unedo Standard / Strawberry Tree	24"box
	ARB MAR	Arbutus x 'Marina' / Marina Strawberry Tree	24"box
	CED DEO	Cedrus deodara / Deodar Cedar	15 gal
	CER FOR	Cercis canadensis 'Forest Pansy' / Forest Pansy Eastern Redbud	15 gal
	COR FLO	Cornus florida / Flowering Dogwood	15 gal
	LAG CAT	Lagerstroemia indica 'Catanba' / Catanba Grape Myrtle	15 gal
	LAG NAT	Lagerstroemia indica x fauriei 'Natchez' / Natchez Grape Myrtle	24"box
	PIN ELD	Pinus eldarica / Mondell Pine	15 gal
	PIS KEI	Pistacia chinensis 'Keith Davey' / Keith Davey Chinese Pistache	24"box
	PLA COL	Platanus x acerifolia 'Columbia' / Columbia London Plane Tree	15 gal
	PRU CAR	Prunus caroliniana / Carolina Laurel Cherry	24"box
	PRU SER	Prunus serrulata 'Kanzan' / Japanese Flowering Cherry	24"box
	ULM TRU	Ulmus parvifolia 'True Green' / True Green Lacebark Elm	24"box
SHRUBS	CODE	BOTANICAL / COMMON NAME	SIZE
	BER HEL	Berberis thunbergii 'Helmond Pillar' / Columnar Red Barberry	5 gal
	CAL LIT	Callistemon citrinus 'Little John' / Dwarf Bottle Brush	1 gal
	CAR ELI	Carpenteria californica 'Elizabeth' / Bush Anemone	5 gal
	CIS PUR	Cistus x purpureus / Orchid Rockrose	5 gal
	DIA LIT	Dianella revoluta 'Little Rev' / Little Rev Flax Lily	1 gal
	DIE BIC	Dietes bicolor / Fortnight Lily	5 gal
	DOD PUR	Dodonaea viscosa 'Purpurea' / Purple Leafed Hopseed Bush	5 gal
	GRE NOE	Grevillea x 'Noellii' / Grevillea	5 gal
	HEM ORO	Hemerocallis x 'Stella de Oro' / Yellow Daylily	1 gal
	LAV PRO	Lavandula x intermedia 'Provence' / Provence French Lavender	1 gal
	LOR SIZ	Loropetalum chinense 'Sizzling Pink' / Sizzling Pink Fringe Flower	5 gal
	MAH COM	Mahonia aquifolium 'Compacta' / Compact Oregon Grape	1 gal
	MAH SOF	Mahonia eurybracteata 'Soft Caress' / Soft Caress Mahonia	1 gal
	NAN BLU	Nandina domestica 'Blush Pink' / Heavenly Bamboo	1 gal
	NAN COM	Nandina domestica 'Compacta' / Dwarf Heavenly Bamboo	1 gal
	PHO MAO	Phormium tenax 'Maori Maiden' / New Zealand Flax	5 gal
	PHO FRA	Photinia x fraseri / Photinia	5 gal
	SAL GRE	Salvia greggii 'Heatwave Blaze' / Heatwave Blaze Salvia	1 gal

GRASSES	CODE	BOTANICAL / COMMON NAME	SIZE	
	CAL KAR	Calamagrostis x acutiflora 'Karl Foerster' / Feather Reed Grass	1 gal	
	LOM BRE	Lomandra longifolia 'Breeze' / Dwarf Mat Rush	1 gal	
	MUH REG	Muhlenbergia capillaris 'Regal Mist' / Pink Muhly	1 gal	
	MUH RIG	Muhlenbergia rigens / Deer Grass	1 gal	
VINES	CODE	BOTANICAL / COMMON NAME	SIZE	
	CLY CAL	Clytostoma callistegioides / Violet Trumpet Vine	5 gal	
GROUND COVERS	CODE	BOTANICAL / COMMON NAME	SIZE	SPACING
	ARC ECP	Arctostaphylos x 'Emerald Carpet' / Emerald Carpet Manzanita	1 gal	36" o.c.
	CEA YAN	Ceanothus griseus horizontalis 'Yankee Point' / California Lilac	1 gal	60" o.c.
	ROS DNA	Rosmarinus officinalis 'Prostratus' / Dwarf Rosemary	1 gal	48" o.c.
	TRA JAS	Trachelospermum jasminoides / Star Jasmine	1 gal	48" o.c.
SYNTHETIC TURF	CODE	BOTANICAL / COMMON NAME	SIZE	SPACING
	SYN TUR	Synthetic Turf	sod	

PLANTING STATEMENT

The landscape plant palette consists of low water use shrubs, ground covers, trees, and ornamental grasses that are considered low maintenance and hardy. Choice of plants is guided by considerations of solar exposure and climate conditions of the site. Plant selection aims for longevity by selecting plants that are long lived varieties of trees, shrubs, ground covers, and grasses.

Plant design varies in form, texture and color. Informal planting patterns are preferred over uniform symmetrical planting patterns. Use of flowering trees and colorful plantings have been located at pedestrian and driveway entries. Planting design takes ease of maintenance into consideration by minimizing some of the following: plant material that may attract or harbor pests/disease; trees that drop extreme amounts of litter (e.g. Liquidambar, fruit trees, etc.); plant material with a mature size larger than the space provided for growth; perennial plants that die back in winter months.

All planted areas shall be properly amended, compacted and finish graded prior to planting. A pre-emergent herbicide will be installed in all shrub and groundcover planting areas to control weeds. All landscape areas will be top dressed with a 3-inch depth of shredded bark mulch (no shredded Redwood).

Shrubs and ground covers will be no less than 1-gallon size. Trees no less than 24" box size. Plant materials shall be spaced to provide substantial cover, but also to allow adequate room to mature into their natural form and ultimate size without required pruning.

IRRIGATION STATEMENT

The irrigation system will be serviced by a new point of connection. The irrigation design will consist of low volume point source drip irrigation. Proposed trees shall utilize bubbler irrigation to encourage deep root watering. The overall irrigation system will be designed with a smart irrigation controller. A weather sensor will be used to automatically adjust duration of application in accordance with recent weather conditions based on evapotranspiration. Maximum water allowance will be determined by State code. To also be consistent with the planting design, the irrigation design shall incorporate hydrozones by locating plants of different water needs into groups for ease of water application.

PARKING LOT SHADE CALCULATIONS

TREE SYMBOL	100%	75%	50%	25%
ARB. MAR.			2 (157) = 315	
PIS. KEI.		1 (707) = 707	9 (481) = 4,329	
PLA. COL.	2 (962) = 1,924		13 (481) = 6,253	
ULM. TRU.	5 (962) = 4,810		6 (481) = 2,886	
PARKING LOT AREA	37,984 s.f.			
SHADE REQUIRED (50%)	18,992 s.f.			
TOTAL SHADE	21,224 s.f.			
PERCENT SHADE	56%			

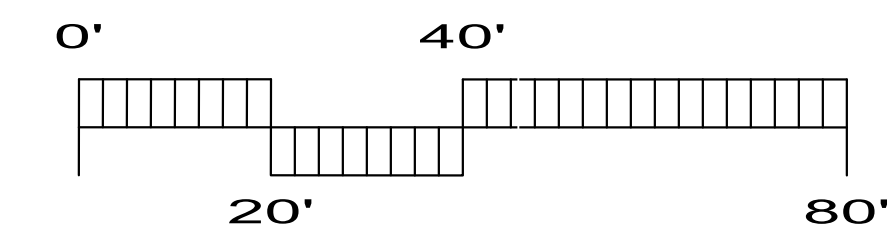

YAMASAKI
LANDSCAPE ARCHITECTURE

JEFF AMBROSIA, ASLA C4057

1223 HIGH STREET
AUBURN, CALIFORNIA 95603
(530) 885-0040
FAX (530) 885-0042
www.yamasaki-la.com

**WESTPARK W16 APARTMENTS
LANDSCAPE DEVELOPMENT PLANS
PLEASANT GROVE BOULEVARD
ROSEVILLE, CALIFORNIA**

These drawings are instruments of service and are the property of Yamasaki Landscape Architecture. All designs and other information on the drawings are for the use on the specified project and shall not be used otherwise without the express written permission of Yamasaki Landscape Architecture.

Sheet Title
PLANT SCHEDULE



No.	Date	Revision
▲		
▲		
▲		
▲		

Project Mgr.: JMA Sheet No.:
Drawn By: JMA
Scale: **L1.5**
Date: 4/2/21
File Name: W16 PL of _____ sheets

S:\049\Westpark W16 Apartments\DWG\A\DWG\W16_PL.sch.dwg 2022 03:37 PM by: Jeff Ambrosia